

# MALLARD

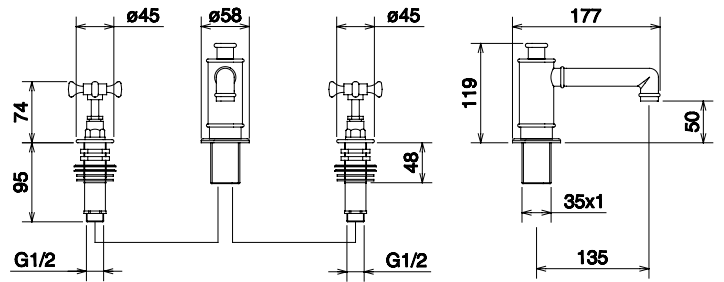

3 Pce Deck Basin Mixer

scheda tecnica

technical data

Batteria lavabo 3 fori con scarico  
3 holes wash basin with pop-up waste

Chrome - Polished Nickel

- Lavabo 3 fori
- Vitone GN90 1/2 con dischi ceramici (certificato)
- A richiesta vitone tipo meccanico
- Scarico con piletta in ottone
- Attacchi all' impianto idrico G1/2
- Flex inox per collegamento alla bocca
- Bocca fissa con areatore Cache' Neoperl 18x1.5 TJ
- Completamente in ottone
- Garanzia 5 anni

- 3 holes wash
- GN90 1/2 screw with ceramics discs (certificate)
- Traditional mechanism available to request
- Brass pop-up waste
- Water supply connections G1/2
- Flex inox for connection to the spout
- Fixed spout with areator Cache' Neoperl 18x1.5 TJ
- Completely brass made
- 5 years guarantee

- Portata 14 litri/min (3 bar)

- Flow rate 14 liters/min (3bar)

- Riferimenti normative:
- EN 200 - EN32
- EN 248

- Reference standards:
- EN 200 - EN32
- EN 248

- Forature piano (mm):
- Piantane acqua calda/fredda: min30 max 32
- Centrale bocca: min35 max37

- Drilling plan (mm):
- Hot/cold water pedestal: min30 max 32
- Body spout: min35 max37

- Interasse fori piano (mm):
- 200 ±4
- I flex inox di collegamento permettono altre distanze

- Distance center drilling plan (mm):
- 200 ±4
- The flex inox connections allow other distances



Unit A4, Chaucer Business Park  
Watery Lane, Kemsing  
Kent, TN15 6PW  
(t) 01732 760079

www.grangedesign.com  
info@grangedesign.com

